

# CT VACUUM SERVICE KIT



**college park**  
TECHNOLOGY *for the* HUMAN RACE

*technical instructions*

**FIGURE 1**

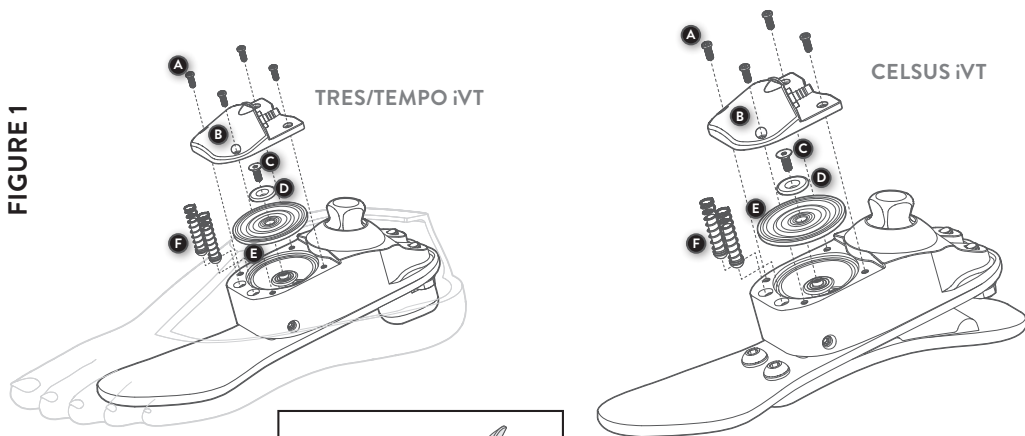

**FIGURE 2**

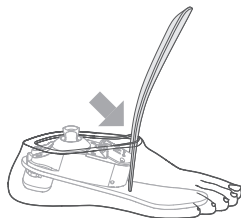

**FIGURE 3**

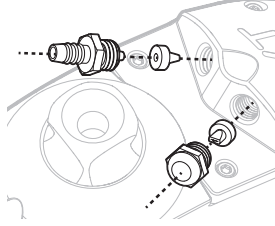

**FIGURE 4**

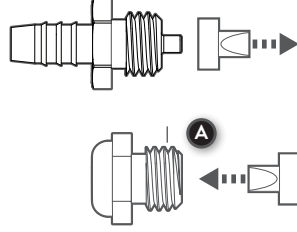

*This diagram (Figure 1) is to help familiarize you with the unique parts of the CT Vacuum Service Kit. These parts are referenced in the instructions and used when speaking with a technical service representative.*

## **Key Components** (Figure 1)

### **FOOT**

- |                          |                       |                         |                       |
|--------------------------|-----------------------|-------------------------|-----------------------|
| A. Housing Cap Fasteners | B. Housing Cap        | C. Air Bladder Fastener | D. Air Bladder Washer |
| E. Air Bladder           | F. Return Springs (2) |                         |                       |

## **PUMP DISASSEMBLY AND REASSEMBLY (FOR MAINTENANCE)**

### **DISASSEMBLY**

1. Disconnect the tube from the hose connector.
2. **Tres/Tempo Foot Only:** Use a Foot Horn or similar blunt tool to fold the opening of the foot shell and access the pump area.
3. Use a T9 torx wrench to loosen the housing cap fasteners, remove the fasteners (Fig 1-A).
4. Release the housing cap (Fig 1-B).
5. Use a T9 torx wrench to loosen the air bladder fastener and remove the washer (Figs 1-C & 1-D).
6. Gently pull the air bladder from the housing (Fig 1-E).
7. Remove the return spring assemblies (Fig 1-F).

**Note:** *Do not disassemble the pump or foot module further. Additional disassembly will void the warranty.*

## REASSEMBLY

1. Install new return spring assemblies.
2. Insert a new air bladder into the housing.
3. Replace the washer and air bladder fastener. Torque to 5 in-lbs (0.6 N-m).
4. Replace the housing cap.
5. Thread the fasteners into the housing. Torque to 5 in-lbs (0.6 N-m).
6. Reconnect the tube to the hose connector and use the tube retainer to secure the tube to the pylon or other adapter.

## REPLACING CHECK VALVES

The hose connector is pre-assembled for a left foot and can be reconfigured for a right foot.

1. Use a 5/16 wrench to loosen the hose connector and exhaust vent (Figures 3-A & 3-B).
2. Replace the check valves (Figure 3-C). Ensure the valves are oriented in the correct direction for proper function (Figure 4).
3. Retighten. Torque to 35 in-lbs (4 N-m).

# NOTES

---

---

---

---

---

---

---

---

---

---

[illegible]



**MADE IN THE USA**

©2022 College Park Industries, Inc. All rights reserved.



1088 INS IVT SK TIS 220613

**COLLEGE PARK INDUSTRIES, INC**   
27955 College Park Dr. Warren, MI 48088 USA

**EMERGO EUROPE**   
Prinsessegracht 20, 2514 AP The Hague, Netherlands

**Australian Sponsor**  
**EMERGO AUSTRALIA**  
Level 20, Tower II, Darling Park, 201 Sussex Street,  
Sydney, NSW 2000 Australia