

Stride Control Adjustment

The adjustable Stride Control gives you the ability to customize an individual's gait timing, fine-tuning the foot's response by either turning it clockwise/ counterclockwise. This adjustment affects both plantar and dorsiflexion resistance without the need to change soft components.

The Onyx adjustable multi-axial rotation unit ships with a medium Stride Control setting. If new bumpers are fitted, set the preload to 3-turns (medium preload) from the point of initial contact with the ankle bone. *If an additional 1-1/2 turns are required to attain the desired resistance, then a change in bumpers is recommended.*

Dynamic Adjustments

DESIRED RESULT	ALIGNMENT CHANGE	COMPONENT CHANGE
Firmer Toe Response	Plantarflex the Onyx or move load line posterior	none
Softer Toe Response	Dorsiflex the Onyx or move load line anterior	none
Firmer Heel Response	Dorsiflex the Onyx or move load line anterior	Increase Stride Control Rear Bumper up one step firmer
Softer Heel Response	Plantarflex the Onyx or move load line posterior	Decrease Stride Control Rear Bumper down one step softer

Gait Matching® Guidelines

Contact College Park Technical Service if you have questions about modifying the gait match.

Warranty Inspection and Maintenance Information

College Park recommends that you schedule your patients for check-ups according to the warranty inspection schedule below.

High patient weight and/or impact level may require more frequent inspections. Soft component wear depends on the patient weight, impact level and environment. We recommend you inspect the following applicable parts for excessive wear and fatigue at each warranty inspection and replace as needed.

- Soft components (disassemble, inspect & re-lubricate)
- CPI Sock
- Composites and Adapters
- Foot Shell

WARRANTY INSPECTION SCHEDULE FOR ONYX: SIX MONTHS, THEN ANNUALLY.

Technical Assistance / Emergency Service 24-7-365

College Park's regular office hours are Monday thru Friday, 8:30 AM – 5:30 PM (EST). After hours, an emergency Technical Service number is available to contact a College Park representative.



MADE IN THE USA
187 INS OX TIS 170821

COLLEGE PARK INDUSTRIES, INC
27955 College Park Dr.
Warren, MI 48088 USA

EC REP

EMERGO EUROPE
Prinsessegracht 20, 2514 AP
The Hague, Netherlands

Australian Sponsor
EMERGO AUSTRALIA
Level 20, Tower II
Darling Park
201 Sussex Street
Sydney, NSW 2000
Australia

©2017 College Park Industries, Inc. All rights reserved. College Park, StrideControl, and Onyx are registered trademarks of College Park Industries.

TECHNICAL INSTRUCTIONS



FEATURING:

- Dynamic Pylon
- Tri-axial function
- Adjustable StrideControl®

PACKAGE CONTENTS	TOOLS REQUIRED
(1) Onyx Foot/Shank System (1) Pylon Adapter (4-hole, Male or Female) (1) Sleeve Adapter (1) CPI Sock (1) Foot Shell (1) TruLube Lubricant	(2) 4 mm Hex Key (1) DP Cutting Jig (Included) RECOMMENDED FootHorn Pin Guide

FOOT COMPONENTS

The following diagram is to help familiarize you with Onyx’s unique parts. They are referenced in the instructions, and used in assembling the foot or talking with technical service.

COMPONENTS

- 1 Pylon Adapter (4-hole, Male or Female)
- 2 Push-out Screw
- 3 Shank Adapter
- 4 Retention Screws (2)
- 5 DP Cutting Jig Tool
- 6 Dynamic Shank
- 7 Brass Sleeve
- 8 Ankle Bushings (2)
- 9 Axial Pin
- 10 Axial Pin Screw
- 11 Rear Bumper
- 12 Anterior Pad*
- 13 Angle Control Shims (2)
- 14 Foreheel
- 15 Foot Shell
- 16 Adjustable multi-axial rotation unit

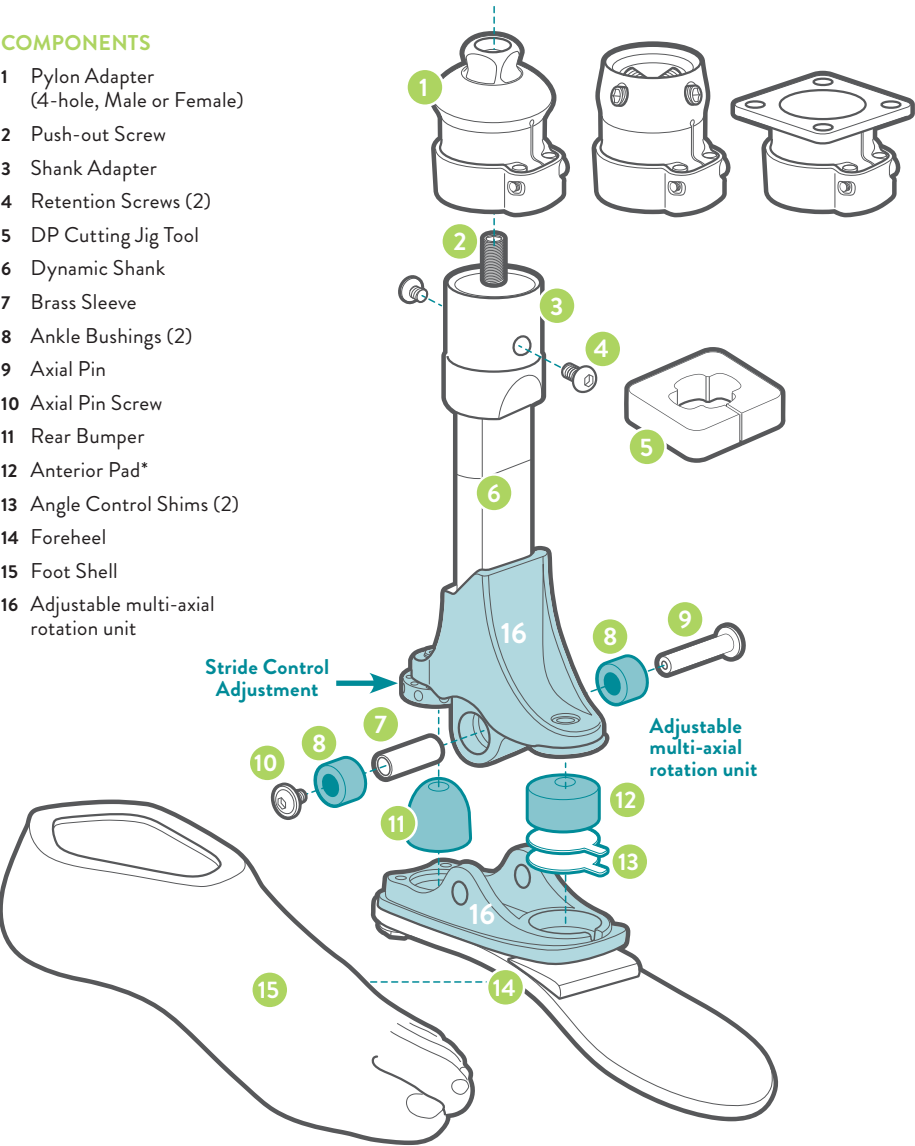

*Note: beveled side of anterior pad is “up.”

GENERAL INSTRUCTIONS

Mounting

Use only high quality proximal endoskeletal components (30 mm). For DP mounting, refer to the Cutting a Dynamic Pylon and DP Sleeve Adapters Tech Tip guides.

Assembly and Disassembly

- 1 Use the FootHorn to don and doff the foot shell. Remove the CPI Sock and replace as needed.
- 2 Use a 4 mm hex key to reduce the preload on the bumpers by turning the Stride Control adjuster counter-clockwise. Record the number of turns for use in re-assembly.
- 3 Use two 4 mm hex keys to remove the axial pin screw.
- 4 Attach the pin guide to the axial pin. Push and rotate clockwise.
- 5 Unscrew the axial pin from the pin guide and remove it from the ankle bone.
- 6 Remove the ankle bone from the foreheel to access the front and rear bumpers. To remove the ankle bushings, first slide out the brass sleeve.
- 7 For re-assembly, lubricate the axial pin, inside and outside of the ankle bushings, ankle bushing pocket, and brass sleeve. Then insert sleeve and reverse the steps 1-6. Torque axial pin screw to 4 N·m (36 in-lbs).

DO NOT lubricate anterior pad or rear bumper.

Static Alignment

For optimal function have the patient’s weight balanced between the forefoot and heel. The load line divides the foot at 1/3 heel lever and 2/3 toe lever.

Angle Control Adjustment

Angle control shims help facilitate plantar-dorsiflexion adjustments for more precise alignment. Each shim includes a tab for easy removal.

The Onyx ships with a medium Angle Control setting (two shims). Each shim represents one degree of angle change. **A maximum of four shims can be used.**

DESIRED RESULT	ANGLE CONTROL	STRIDE CONTROL CHANGE (FULL)
Increase Plantarflexion 1°	Add one shim	Decrease one counter-clockwise
Increase Plantarflexion 2°	Add two shims	Decrease two counter-clockwise
Increase Dorsiflexion 1°	Remove one shim	Increase one clockwise
Increase Dorsiflexion 2°	Remove two shims	Increase two clockwise

WARNING

- Do not expose this product to pH extremes or corrosive materials (water, salt water or other liquids).
- Failure to follow these technical instructions or use of this product outside the scope of its Limited Warranty may result in injury to the patient or damage to the product.
- Any further disassembly or modification of components will void the warranty.
- Onyx is designed as an integrated system that does not function as separate components for ambulation.
- Cannot be used or interchanged with other prosthetic system adapters.