

TRI-AXIAL FUNCTION | HIGHLY CUSTOMIZABLE | VERTICAL COMPLIANCE



Original and unrivaled, the Truststep foot sets the standard for unsurpassed comfort and natural-feeling mobility. It was one of the first to provide correct movement in all planes allowing for nearly the same vertical motion, rotation, and stability as an anatomical foot. With a full range of options available, the versatile design allows complete customization.

INCLUDED

Endo foot includes: foot shell and CPI sock and optional sealing boot

Exo foot includes: foot shell and CPI sock. Exo block sold separately

TRUSTEP PART NUMBER

TS	SIDE	SHELL COLOR*	MOUNTING**	SIZE	WIDTH†	FIRMNESS CATEGORY
	L OR R	C, T, B OR J	EN OR ALX	22-31	N OR W	D 1-9

*(C)aucasian, (T)an, (B)rown or (J)et Black. **(EN)do, Exo (ALX). †(N)arrow or (W)ide. Wide only available in 24-31cm. Example part number: TS LCEN 24N D6

ENVIROSHELL PART NUMBER

TS	EXO*	SIDE	SHELL COLOR**	SIZE	WIDTH†
	X S	L OR R	C, T, B OR J	22-31	N OR W

*E(X)o foot shell. Leave blank for Endo. Exo shells require an extra day for processing. **Caucasian, Tan, Brown, or Jet Black. †Wide shell only available in 24-31cm.



*26 cm with Enviroshell. **The listing of codes with these products should not be construed as a guarantee for coverage or payment. Ultimate responsibility for the coding of services/products rests with the individual practitioner. ***Caucasian, Tan, Brown, or Jet Black.

TECHNICAL SPECIFICATIONS

FUNCTION	Tri-Axial
SIZES	22-31 cm
MOUNTING	Endo (IP) Exo (ALX)
WEIGHT LIMIT	330 lbs (Endo) 352 lbs (Exo)
WARRANTY	3 years
BUILD HEIGHT	3.5 in (IP) 6.0 in (ALX)
WEIGHT*	678 g
L-CODE** L5979 PDAC APPROVED	IMPACT LEVEL 
WATER CAPABILITY  Weatherproof	ENVIROSHELL*** 

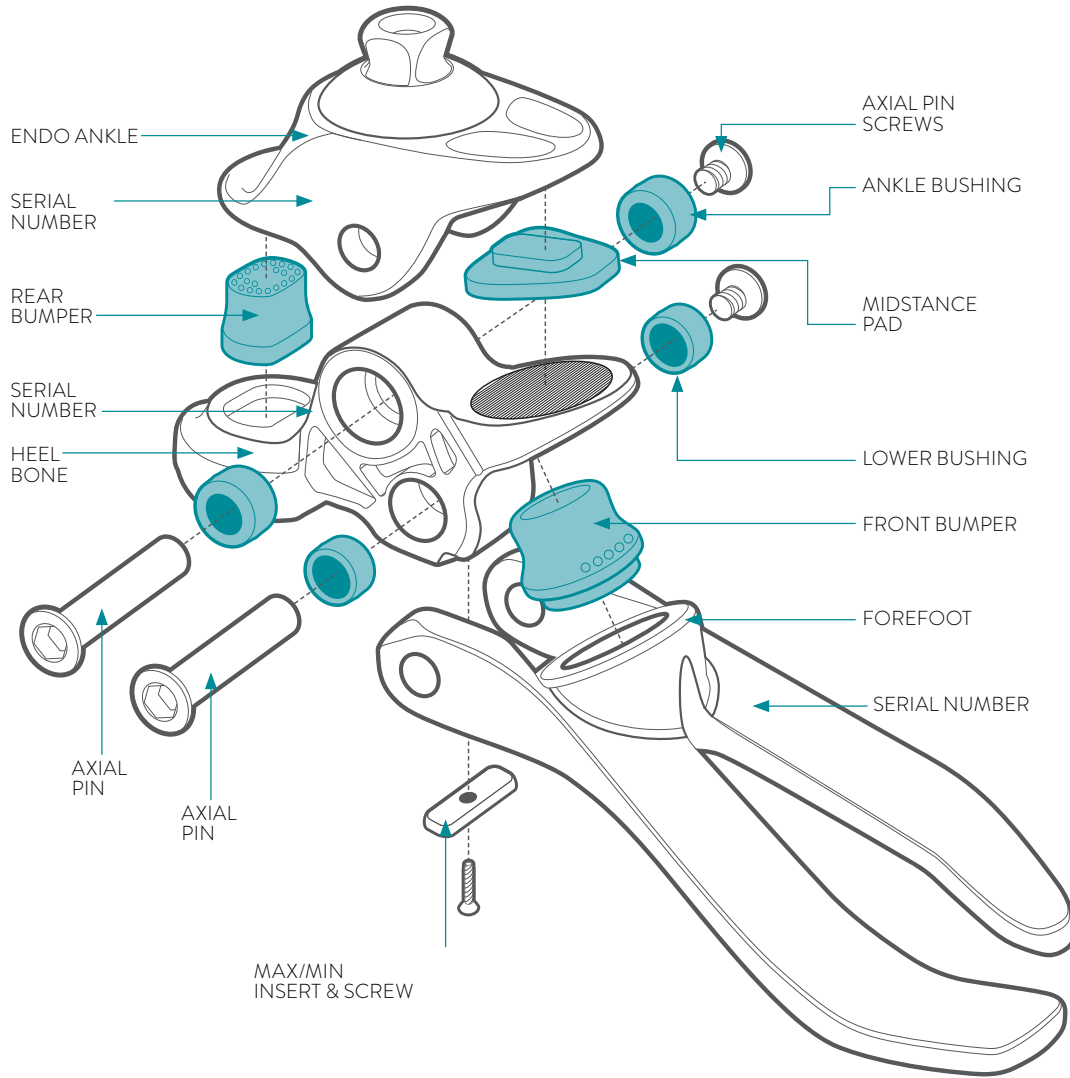

GAIT MATCHING

COMPONENT	FIRMNESS CATEGORY								
	1	2	3	4	5	6	7	8	9
Front Bumper	1	2	3	4	5	6	7	8	8
Ankle Bushings	S	S	S	S	M	M	M	F	F
Midstance Pad	M	M	M	M	M	M	M	F	F
Rear Bumper	XS	XS	S	S	M	H	1X	2X	3X
Lower Bushings	ONE FIRMNESS								

TRUSTEP FIRMNESS CATEGORIES

PATIENT WEIGHT	0-74lbs	75-100	101-120	121-140	141-160	161-180	181-200	201-220	221-250	251-275	276-300	301-330	331-352
SIZE	22-31cm												EXO ONLY
LOW IMPACT	1	2	3	4	4	5	6	6	7	7	8	8	9
MOD IMPACT	1	2	3	4	5	6	6	7	7	7	8	9	9
HIGH IMPACT	2	3	4	5	6	6	7	7	8	8	8	9	9

SOFT COMPONENTS	PART NO.	DESCRIPTION
	KTS TSB	Truststep Bumper Kit (See page 51 for contents)
	TS FB 1	Front Bumper #1
	TS FB 2	Front Bumper #2
	TS FB 3	Front Bumper #3
	TS FB 4	Front Bumper #4
	TS FB 5	Front Bumper #5
	TS FB 6	Front Bumper #6
	TS FB 7	Front Bumper #7
	TS FB 8	Front Bumper #8
	TS FB 9	Front Bumper #9

SOFT COMPONENTS	PART NO.	DESCRIPTION
	TS RB XS	Rear Bumper, XS
	TS RB S	Rear Bumper, S
	TS RB M	Rear Bumper, M
	TS RB H	Rear Bumper, H
	TS RB 1X	Rear Bumper, 1X
	TS RB 2X	Rear Bumper, 2X
	TS RB 3X	Rear Bumper, 3X

SOFT COMPONENTS	PART NO.	DESCRIPTION
	TS MP M	Midstance Pad, Medium
	TS MP F	Midstance Pad, Firm
	TS LB	Lower Bushing
	TS AB S	Ankle Bushing, Soft
	TS AB M	Ankle Bushing, Medium
	TS AB F	Ankle Bushing, Firm
	TS AB R	Ankle Bushing, Rigid

FIRMNESS COLOR CODE: SOFT MEDIUM FIRM RIGID

HARDWARE	PART NUMBER	DESCRIPTION
	CP AP L	Axial Pin, Long, 22-31cm
	CP APS	Axial Pin Screw
	TS MAX MH	Max Insert, Molded Heel
	TS MIN MH	Min Insert, Molded Heel
	TS IS MH	Max/Min Insert Screw, Molded Heel
	TS S10 25	Exo Mounting Bolt, M10 x 25mm
	TS RBK	Pyramid Tool Retaining Bolt Kit (4pc) M6 x 12mm
	CP SSET	Super Set Screws (8pc) M8 x 14mm

TOOLS	PART NUMBER	DESCRIPTION
	KTS TSG	Truststep Gait Matching Kit (See page 51 for contents)
	KTS 200 TK	Truststep Tool Kit (See page 51 for contents)
	TPT 700	Truststep Preloader Tool
	TFH 800	Foot Horn, Stainless Steel
	TGP 525	Pin Guide
	CP HK 4	Hex Key, 4mm
	TL LUB	TruLube Lubricant, 0.25 oz.

SEALING BOOTS	PART NUMBER (LEFT/RIGHT)	DESCRIPTION	ADDITIONAL INFORMATION
	TS SBLΔ 2224	TS SBRΔ 2224	Sealing Boot (left or right), 22-24cm
	TS SBLΔ 2526	TS SBRΔ 2526	Sealing Boot (left or right), 25-26cm
	TS SBLΔ 2730	TS SBRΔ 2730	Sealing Boot (left or right), 27-30cm
			Keeps dirt and debris from the inside of the shell.

Δ Indicate Color. (C)aucasian, (B)rown or (T)an.

SHELLTREAD	PART NUMBER (LEFT/RIGHT)	DESCRIPTION	ADDITIONAL INFORMATION
	TS TLN xx	TS TRN xx	Shelltread (left or right) Neutral (indicate size, width)
	TS TLJ xx	TS TRJ xx	Shelltread (left or right) Jet Black (indicate size, width)
			Increases durability and prevents premature wear of foot shell.

SOCKS	PART NUMBER	DESCRIPTION	ADDITIONAL INFORMATION
	CPI SS SM	CPI Sock, Small, 21-25cm	
	CPI SS LG	CPI Sock, Large, 26-30cm	
	CPI SSK SM	CPI Sock, Small, 21-25cm, 6-pack	
	CPI SSK LG	CPI Sock, Large, 26-30cm, 6-pack	Highly durable sock that acts as a noise barrier and protects the foot from debris.

EXO OPTION

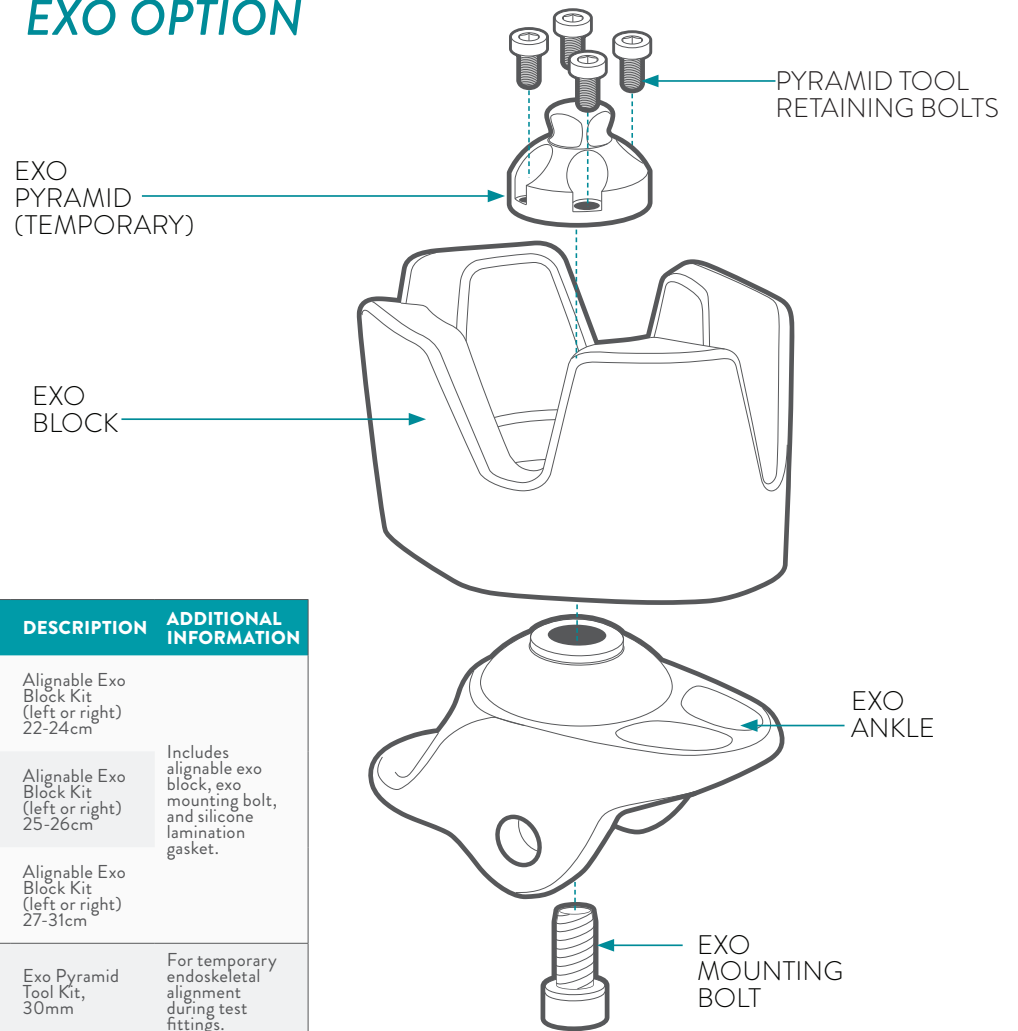

EXO MOUNTING ADAPTERS	PART NUMBER	DESCRIPTION	ADDITIONAL INFORMATION
	TS XBKL 2224 TS XBKR 2224	Alignable Exo Block Kit (left or right) 22-24cm	Includes alignable exo block, exo mounting bolt, and silicone lamination gasket.
	TS XBKL 2526 TS XBKR 2526	Alignable Exo Block Kit (left or right) 25-26cm	
	TS XBKL 2731 TS XBKR 2731	Alignable Exo Block Kit (left or right) 27-31cm	
	TS EXPK 30	Exo Pyramid Tool Kit, 30mm	For temporary endoskeletal alignment during test fittings.

BONE ASSEMBLIES	PART NUMBER	DESCRIPTION	ADDITIONAL INFORMATION
	TS ENA 2224	Endo Ankle, 22-24cm	Available for users up to 330 lbs.
	TS ENA 2531	Endo Ankle, 25-31cm	
	TS ALXA 2224	Exo Ankle, 22-24cm	Available for users up to 352 lbs.
	TS ALXA 2531	Exo Ankle, 25-31cm	
	TS MH 2224	Molded Heel Bone, 22-24cm	
	TS MH 2526	Molded Heel Bone, 25-26cm	
	TS MH 2731	Molded Heel Bone, 27-31cm	
	TS MHK 2224	Molded Heel Bone Kit, 22-24cm	Kit includes heel bone, max insert and max insert screw
	TS MHK 2526	Molded Heel Bone Kit, 25-26cm	
	TS MHK 2731	Molded Heel Bone Kit, 26-31cm	
	TS FF 2224L	TS FF 2224R	Forefoot Bone, 22-24 cm (left or right)
	TS FF xL	TS FF xR	Forefoot Bone, (indicate size: 25-30 cm, left or right)
	TS FF 31		Forefoot Bone, 31 cm