

TECHNICAL SPECIFICATIONS



FUNCTION	MOUNTING	WEIGHT LIMIT		CLEARANCE	
Pediatric Foot	Pyramid	13-15	55 lbs (25 kg)	Pyramid	1.8-2.1 in (4.5-5.3 cm)
	Receiver	16-18	100 lbs (45 kg)	Receiver	2.1-2.4 in (5.3-6.1 cm)
	Exo (ALX)	19-22	132 lbs (60 kg)	Exo (ALX)	4.1-4.3 in (11.0-11.8 cm)
	Lam Adapter			Lam Adapter	1.9-2.1 in (4.8-5.3 cm)
SIZES	WEIGHT*	WARRANTY		L CODES**	
13-22 cm	183-360 g	1 year		L5981 PDAC APPROVED	

IMPACT LEVEL	WATER CAPABILITY
	WATERPROOF IN FRESH WATER
ENVIROSHELL®	

SCOUT PART NUMBER

SC	SIDE	SHELL COLOR***	MOUNTING	SIZE	FIRMNESS CATEGORY
SC	L or R	C, T, or B	M	13-22	D 1-4

*** (C)aucasian, (T)an or (B)rown. Example part number: SC LCM 15 D3

REQUIRED ADAPTER (SCOUT ONLY)

DESCRIPTION	PART #
Threaded Adapter, SS, Pediatric	TA SP
Threaded Receiver, SS, Pediatric	TR SP
Threaded Exo Adapter, SS, Pediatric**	TXA SP
Threaded Lamination Adapter, Small, SS, Pediatric	TLAS SP
Threaded Lamination Adapter, Medium, SS, Pediatric	TLAM SP
Threaded Lamination Adapter, Large, SS, Pediatric	TLAL SP

Order adapter as a separate line item.



FUNCTION	MOUNTING	WEIGHT LIMIT		CLEARANCE	
Pediatric Foot	Endo (IP)	16-18	100 lbs (45 kg)	Endo (IP)	2.1-2.4 in (5.3-6.1 cm)
	Exo (ALX)	19-21	132 lbs (60 kg)	Exo (ALX)	4.3-4.6 in (11.0-11.8 cm)
SIZES	WEIGHT†	WARRANTY		L CODES**	
16-21 cm	215-314 g	1 year		L5979 PDAC APPROVED	

IMPACT LEVEL	WATER CAPABILITY
	WEATHERPROOF
ENVIROSHELL®	

TRUPER PART NUMBER

TP	SIDE	SHELL COLOR***	MOUNTING	SIZE	FIRMNESS CATEGORY
TP	L or R	C, T, or B	EN, or ALX	16-21	D 1-3

*** (C)aucasian, (T)an or (B)rown. Example part number: TP LCEN 19 D3

*13-22 cm model, including Pyramid Adapter and Enviroshell. †16-21 cm model, including Enviroshell. **The listing of codes with these products should not be construed as a guarantee for coverage or payment. Ultimate responsibility for the coding of services/products rests with the individual practitioner. *** Caucasian, Tan, Brown, or Jet Black. † Low impact only.

ALSO AVAILABLE!



PEDIATRIC ENDO COMPONENTS



TECHNOLOGY for the HUMAN RACE
800.728.7950 | 586.294.7950 | www.college-park.com



1200 LIT BRO PED 260109
©2026, College Park Industries, Inc. All rights reserved.



PEDIATRIC SOLUTIONS

WAYS TO GROW

Our pediatric feet grow with their companions. The Scout foot offers a unique size-up shell, wide size range of 13-22 cm, and stackable growth plates. The Truper foot can adapt quickly to growing kids with custom growth plate kits and interchangeable foreheels. With our products, toddlers, kids, and teens can explore their world freely.

GROW WITH SCOUT

SCOUT GROWTH PLATES

The Scout foot provides the option to easily stack growth plates to accommodate up to 19.5 mm of limb growth.

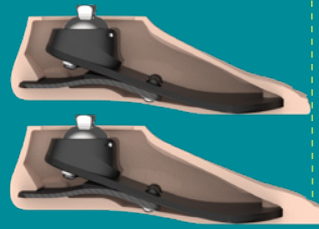
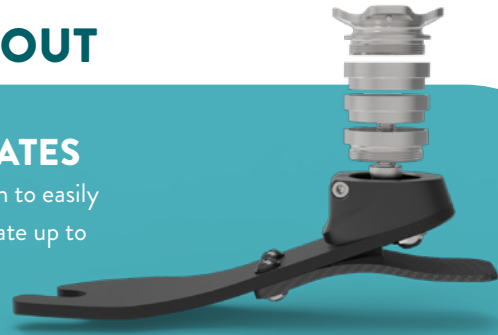

SIZE-UP FOOTSHELLS

The Scout foot offers a unique size-up foot that allows the user to adjust to a larger size without needing a new foot.

**Some restrictions apply.*

SCOUT SIZE-UP SHELL SIZE GUIDE

FOOT SIZE (CM)	13	14	15	16	17	18	19	20	21
Regular Shell (cm)	13	14	15	16	17	18	19	20	21
Size-UP Shell (cm)	13/14	14/15	N/A	16/17	17/18	N/A	19/20	20/21	21/22

GROW WITH TRUPER

TRUPER GROWTH PLATES

The Truper foot can adapt quickly to growing kids with custom growth plate kits and interchangeable foreheels.



L5981**
PDAC APPROVED

ADVENTURE MADE EASY

The Scout foot was designed to offer reliable energy return and growth to keep up with kids. With material fusion, unique growth capabilities, and a wide size range of 13-22 cm, the Scout foot accommodates kids as they age. It also offers four different mounting options. This service-free foot is lightweight, waterproof in fresh water, and built for youth.



SERVICE-FREE
DESIGN



MOUNTING
OPTIONS

13-22
cm

WIDE
SIZE RANGE



WATERPROOF
IN FRESH WATER



MATERIALS MATTER: MATERIAL FUSION

Children need durability, movement, and versatility. To achieve this, the Scout foot uses a hybrid material approach—combining Intelliweave® with carbon fiber. College Park's Intelliweave composites are woven by hand in a 3D pattern for ultimate flexibility and strength. The carbon fiber may provide a dynamic response and increased energy return. This material fusion offers children the best of both worlds.



"When we went to Lake Michigan, Sophia was running on the sand without shoes, making sandcastles, and playing in the water. The Scout is the most flexible foot she has worn. She's able to wear sandals again because it fits and feels like a real foot. With past feet, we weren't able to get the strap over top of them. We can now, because the Scout has a much lower profile. Finally finding the right size was also a big deal, and it's been awesome watching it grow her confidence."

- Megan, Sophia's Mom



L5979**
PDAC APPROVED

ANATOMICAL FUNCTION FOR KIDS

The rugged Truper foot combines high energy with stability for active kids. The foot's flexible foreheel and bumpers are built to store energy for a smooth, controlled transition from standing to running. Made to easily adjust for growing children, the Truper foot offers two size ranges that provide flexibility through adolescence.



STRIDE
CONTROL

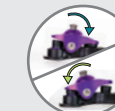

UNPARALLELLED
PLANTARFLEXION / DORSIFLEXION



DESIGNED WITH PLAY IN MIND

The ankle housing is made from high-grade aluminum for fatigue resistance, while the bumpers are made of aircraft-grade polymer for longevity. A redesigned foreheel adds durability, using high-strength nylon and I-beam-style ridges for stability and reinforcement.



**The listing of codes with these products should not be construed as a guarantee for coverage or payment.