

TRI-AXIAL FUNCTION | HIGHLY CUSTOMIZABLE | ADJUSTABLE STRIDE CONTROL



With a full length toe lever, the Venture foot can provide a higher frequency dynamic response for more active users. Highly engineered bumpers and flexible Intelliweave® composites work together for a progressive response. The tri-axial, custom-built foot includes our exclusive Stride Control™ feature for easy fine-tuning without disassembly.

INCLUDED

Endo foot includes: foot shell, cosmetic attachment plate (CAP), CPI sock

Exo foot includes: foot shell and CPI sock. Exo block sold separately

VENTURE PART NUMBER

V	SIDE	SHELL COLOR*	MOUNTING	SIZE	WIDTH	D	FIRMNESS CATEGORY
	L OR R	C, T, B OR J	EN OR ALX	21-30	N OR W		1-5

*(C)aucasian, (T)an, (B)rown or (J)et Black. †(EN)do, Exo (ALX). ‡(N)arrow or (W)ide. Example part number: V L CEN 24W D4

BUILD HEIGHT

	21-24 cm	25-30 cm
IP	2.5 in	5.0 in
ALX	2.7 in	5.2 in



ENVIROHELL PART NUMBER

V S	SIDE	SHELL COLOR**	SIZE	WIDTH
	L OR R	C, T, B OR J	25-30	N OR W

** (C)aucasian, (T)an, (B)rown or (J)et Black.



TECHNICAL SPECIFICATIONS

FUNCTION	Tri-Axial
SIZES	21-30 cm
MOUNTING	Endo (IP) Exo (ALX)
WEIGHT LIMIT	250 lbs (21-24 cm) 275 lbs† (25-30 cm)
WARRANTY	3 years
WEIGHT*	585 g
L-CODE** L5981, L5986	IMPACT LEVEL 
WATER CAPABILITY  Weatherproof	ENVIROHELL*** 

*26 cm model, including Enviroshell. **The listing of codes with these products should not be construed as a guarantee for coverage or payment. Ultimate responsibility for the coding of services/products rests with the individual practitioner. ***Caucasian, Tan, Brown or Jet Black. †Low impact only.

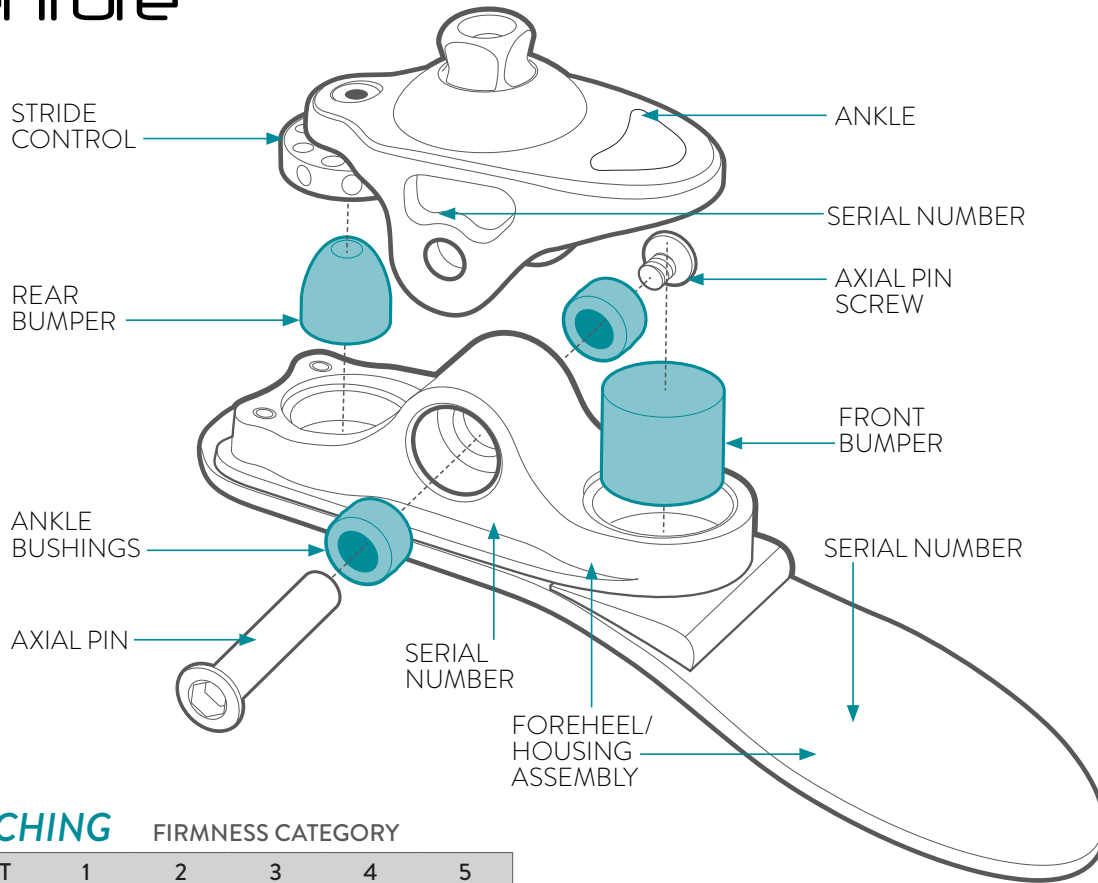

GAIT MATCHING

FIRMNESS CATEGORY

COMPONENT	1	2	3	4	5
Front Bumper	S	M	M	M	M
Ankle Bushings	S	M	M	M	F
Rear Bumper	S	S	M	F	XF

FIRMNESS COLOR CODE: ■ SOFT ■ MEDIUM ■ FIRM

*Pocket size: 21-24cm: C, 25-26cm: B, 27-30cm: A
 †Pocket size: 21-24cm: D, 25-26cm: C, 27-30cm: B

SOFT COMPONENTS	PART NO.	DESCRIPTION
	V BK 2130	Venture & Tribute Bumper Kit (See page 58 for contents)
	V FBS x	Front Bumper, Soft (indicate pocket size*)
	V FBM x	Front Bumper, Medium (indicate pocket size*)
	V FBF x	Front Bumper, Firm (indicate pocket size*)
	V RBS x	Rear Bumper, Soft (indicate pocket size†)
	V RBM x	Rear Bumper, Medium (indicate pocket size†)
	V RBF x	Rear Bumper, Firm (indicate pocket size†)

SOFT COMPONENTS	PART NO.	DESCRIPTION
	V RBX x	Rear Bumper, Extra Firm (indicate pocket size†)
	TS ABS	Ankle Bushing, Soft, 21-30cm
	TS ABM	Ankle Bushing, Medium, 21-30cm
	TS ABF	Ankle Bushing, Firm, 21-30cm
	V ABS 2530	Ankle Bushing, Soft, 25-30cm
	V ABM 2530	Ankle Bushing, Medium, 25-30cm
	V ABF 2530	Ankle Bushing, Firm, 25-30cm

VENTURE FIRMNESS CATEGORIES

PATIENT WEIGHT	0-100lbs	101-120	121-140	141-160	161-180	181-200	201-220	221-250	251-275
SIZE	21-24cm								
LOW IMPACT	1	1	2	3	3	4	4	5	
MODERATE IMPACT	1	2	3	3	4	4	5	5	
HIGH IMPACT	2	3	3	3	4	4	5	5	
IMPACT LEVEL	25-30cm								
LOW IMPACT	1	1	2	3	3	4	4	5	5
MODERATE IMPACT	1	2	3	3	4	4	5	5	
HIGH IMPACT	2	3	3	4	4	4	5	5	

EXO MOUNTING ADAPTERS	PART NUMBER	DESCRIPTION
	V XBK 2124	Alignable Exo Block Kit, 21-24cm
	V XBK 2526	Alignable Exo Block Kit, 25-26cm
	V XBK 2730	Alignable Exo Block Kit, 27-30cm
	V GPK 7	Growth Plate Kit, 7mm
	V GPK 14	Growth Plate Kit, 14mm
	V GPK 21	Growth Plate Kit, 21mm
	V GPK 28	Growth Plate Kit, 28mm
	TS EXPK 30	Exo Pyramid Tool Kit, 30mm

HARDWARE	PART NUMBER	DESCRIPTION
	CP AP SH	Axial Pin, Short, 22-24cm
	CP AP L	Axial Pin, Long, 25-30cm
	CP APS	Axial Pin Screw
	TS S10 25	Exo Mounting Bolt, M10 x 25mm
	V B10 35	Exo Mounting Bolt, M10 x 35mm
	V B10 45	Exo Mounting Bolt, M10 x 45mm
	TS RBK	Pyramid Tool Retaining Bolt Kit, (4pc) M6 x 12mm
	CP SSET	Super Set Screws (8pc) M8 x 14mm

BONE ASSEMBLIES	PART NUMBER	DESCRIPTION
	V ENA 2124	Endo Ankle, 21-24cm
	V ENA 2530	Endo Ankle, 25-30cm
	V ALXA 2124	Exo Ankle, 21-24cm
	V ALXA 2530	Exo Ankle, 25-30cm
	V FHAL x V FHAR x	Foreheel (indicate left or right, size). Requires firmness.

EXO OPTION

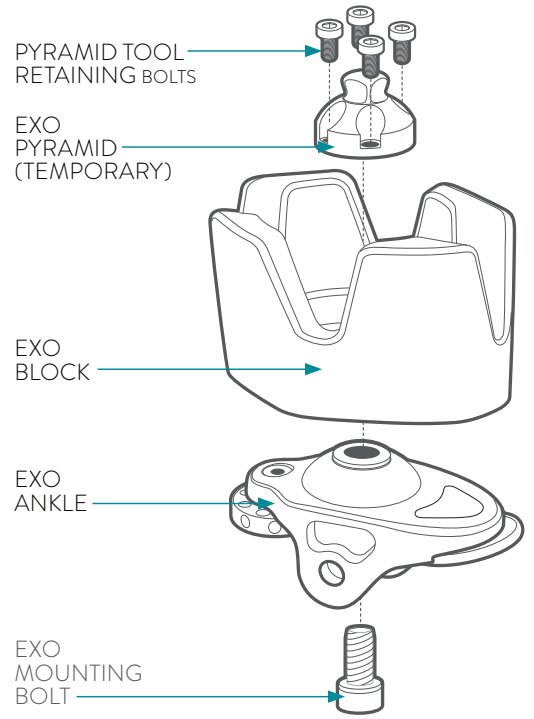

TOOLS	PART NUMBER	DESCRIPTION
	TFH 800	Foot Horn, Stainless Steel
	TGP 525	Pin Guide
	CP HK 4	Hex Key, 4mm
	TL LUB	TruLube Lubricant, 0.25 oz.

COSMETIC ATTACHMENT PLATE (CAP)	PART NUMBER (LEFT/RIGHT)	DESCRIPTION	ADDITIONAL INFORMATION
	V CLΔ 2526 V CRΔ 2526	Cosmetic Attachment Plate (left or right), 25-26cm	Plastic ring snaps into foot shell for easy cosmetic finishing.
	V CLΔ 2730 V CRΔ 2730	Cosmetic Attachment Plate (left or right), 27-30cm	

Δ Indicate Color. (C)aucasian, (B)rown or (T)an.

SHELLTREAD	PART NUMBER (LEFT/RIGHT)	DESCRIPTION	ADDITIONAL INFORMATION
	HZ TLN x HZ TRN x	Shelltread (left or right), Neutral (indicate size)	Increases durability and prevents premature wear of foot shell.

SOCKS	PART NUMBER	DESCRIPTION	ADDITIONAL INFORMATION
	CPI SS SM	CPI Sock, Small, 21-25cm	Highly durable sock that acts as a noise barrier and protects the foot from debris.
	CPI SS LG	CPI Sock, Large, 26-30cm	
	CPI SSK SM	CPI Sock, Small, 21-25cm, 6-pack	
	CPI SSK LG	CPI Sock, Large, 26-30cm, 6-pack	