

TRI-AXIAL FUNCTION | HIGHLY CUSTOMIZABLE | EASY GROWTH CAPABILITIES



The rugged Truper foot combines high energy with stability for active kids. The foot's flexible foreheel and bumpers were designed to store energy for a smooth, controlled transition from standing to running. Made to easily adjust for growing children, the Truper foot offers two size ranges that provide flexibility through adolescence.

INCLUDED

Endo foot includes: foot shell and CPI sock and optional sealing boot

Exo foot includes: foot shell and CPI sock. Exo block sold separately

TRUPER PART NUMBER

TP	SIDE	SHELL COLOR*	MOUNTING	SIZE	D	FIRMNESS CATEGORY
	L OR R	C, T OR B	EN OR ALX	16-21		1-3

*(C)aucasian, (T)an or (B)rown. †(EN)do, Exo (ALX). Shell width is standard. Example part number: TP LCEN 17 D2

BUILD HEIGHT

	16-18 cm	19-21 cm
IP	2.1 in	2.4 in
ALX	4.3 in	4.6 in

TRUPER FIRMNESS CATEGORIES

PATIENT WEIGHT	0-49lbs	50-74	75-100	101-132
SIZE	16-21cm			19-21cm
HIGH IMPACT	1	2	3	3

TECHNICAL SPECIFICATIONS

FUNCTION	Pediatric
SIZES	16-21 cm
MOUNTING	Endo (IP) Exo (ALX)
WEIGHT LIMIT	100 lbs (16-18 cm) 132 lbs (19-21 cm)
WARRANTY	1 year
WEIGHT*	215 g (16 cm) 314 g (21 cm)
L-CODE** L5979 PDAC APPROVED	IMPACT LEVEL
WATER CAPABILITY Weatherproof	ENVIROHELL***

ENVIROHELL PART NUMBER

TP	EXO*	S	SIDE	SHELL COLOR**	SIZE
	X		L OR R	C, T OR B	16-21

*E(X)o foot shell. Leave blank for Endo. Exo shells require an extra day for processing. **(C)aucasian, (T)an or (B)rown.



*Including Enviroshell. **The listing of codes with these products should not be construed as a guarantee for coverage or payment. Ultimate responsibility for the coding of services/products rests with the individual practitioner. ***Caucasian, Tan, or Brown.

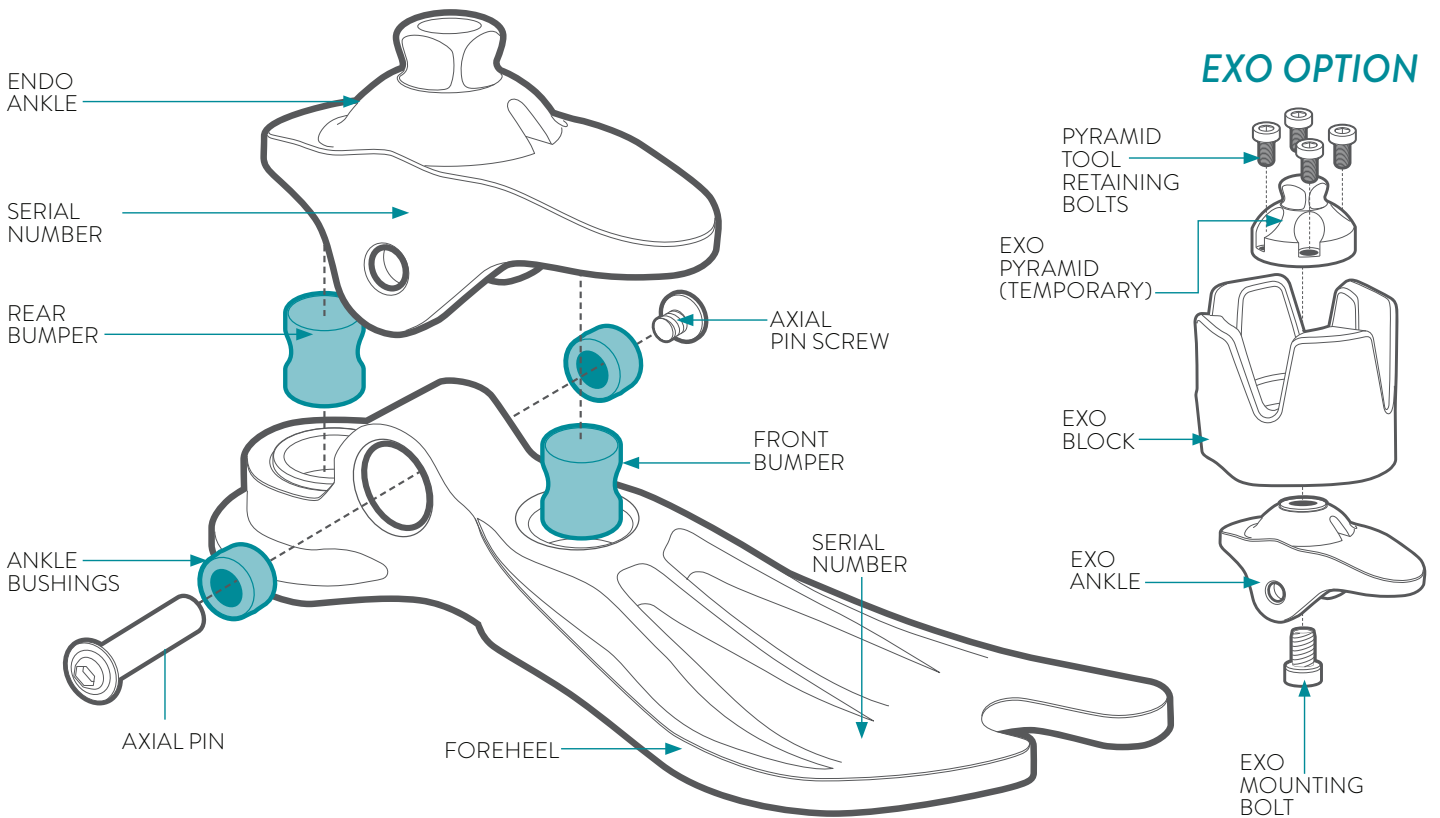

GAIT MATCHING

FIRMNESS CATEGORY

COMPONENT	1	2	3
Front Bumper	S	M	F
Rear Bumper	S	M	F
Ankle Bushings	ONE FIRMNESS		

FIRMNESS COLOR CODE:

- SOFT
- MEDIUM
- FIRM

SOFT COMPONENTS	PART NO	DESCRIPTION
	TP BK 1618	Truper Bumper Kit, 16-18cm (See page 64 for contents)
	TP BK 1921	Truper Bumper Kit, 19-21cm (See page 64 for contents)
	TP BS 1618	Bumper, Soft, 16-18cm
	TP BS 1921	Bumper, Soft, 19-21cm

SOFT COMPONENTS	PART NO	DESCRIPTION
	TP BM 1618	Bumper, Medium, 16-18cm
	TP BM 1921	Bumper, Medium, 19-21cm
	TP BF 1618	Bumper, Firm, 16-18cm
	TP BF 1921	Bumper, Firm, 19-21cm

SOFT COMPONENTS	PART NO	DESCRIPTION
	TP ABM 1618	Ankle Bushing, 16-18cm
	TP ABM 1921	Ankle Bushing, 19-21cm

BONE ASSEMBLIES	PART NUMBER	DESCRIPTION
	TP ENA 1618	Endo Ankle, 16-18cm
	TP ENA 1921	Endo Ankle, 19-21cm
	TP ALXA 1618	Exo Ankle, 16-18cm
	TP ALXA 1921	Exo Ankle, 19-21cm
	TP FHAL x TP FHAR x	Foreheel (indicate left or right, size)

HARDWARE	PART NUMBER	DESCRIPTION
	TP AP 1618	Axial Pin, 16-18cm
	TP AP 1921	Axial Pin, 19-21cm
	CP APS	Axial Pin Screw
	TP SH 8X16	Exo Mounting Bolt, M8 x 16mm
	TP SH 8X30	Exo Mounting Bolt, M8 x 30mm
	TP RBK	Pyramid Tool Retaining Bolt Kit (4pc) M5 x 10mm
	TP DP 4X12	Dowel Pin, M4 x 12mm
	TP DP 4X8	Dowel Pin, M4 x 8mm

EXO MOUNTING ADAPTERS	PART NO	DESCRIPTION	
	TP XBKL 1618	TP XBKR 1618	Alignable Exo Block Kit (left or right) 16-18cm
	TP XBKL 1921	TP XBKR 1921	Alignable Exo Block Kit (left or right) 19-21cm
	TP GKLC 1618	TP GKRC 1618	Growth Plate Kit (left or right) Caucasian, 16-18cm
	TP GKLB 1618	TP GKRB 1618	Growth Plate Kit (left or right) Brown, 16-18cm
	TP GKLC 1921	TP GKRC 1921	Growth Plate Kit (left or right) Caucasian, 19-21cm
	TP GKLB 1921	TP GKRB 1921	Growth Plate Kit (left or right) Brown, 19-21cm
	TP GP 1618	Growth Plate, 16-18cm 2 growth plates max.	
	TP GP 1921	Growth Plate, 19-21cm 2 growth plates max.	
	TP EXPK 22	Exo Pyramid Tool Kit, 22 mm. For temporary endoskeletal alignment during test fittings.	

TOOLS	PART NUMBER	DESCRIPTION
	TP GMK 1621	Truper Gait Matching Kit (See page 51 for contents)
	TFH 800	Foot Horn, Stainless Steel
	TP PG	Truper Pin Guide
	CP HK 4	Hex Key, 4mm
	TL LUB	TruLube Lubricant, 0.25 oz.

SEALING BOOTS	PART NUMBER (LEFT/RIGHT)	DESCRIPTION	ADDITIONAL INFORMATION
	TP SBLΔ 1618	TP SBRΔ 1618	Keeps dirt and debris from the inside of the shell.
	TP SBLΔ 1921	TP SBRΔ 1921	

Δ Indicate Color. (C)aucasian, (B)rown or (T)an.

SHELLTREAD	PART NUMBER (LEFT/RIGHT)	DESCRIPTION	ADDITIONAL INFORMATION
	SC TLN x	SC TRN x	Increases durability and prevents premature wear of foot shell.
	TP TLN x	TP TRN x	

FINISHING RINGS	PART NUMBER (LEFT/RIGHT)	DESCRIPTION	ADDITIONAL INFORMATION
	TP FRLC 1618	TP FRRC 1618	Cosmetic foam spacers used to cover growth plates. Snaps into the foot shell. For exoskeletal prostheses only.
	TP FRLC 1921	TP FRRC 1921	
	TP FRLB 1618	TP FRRB 1618	
	TP FRLB 1921	TP FRRB 1921	

SOCKS	PART NUMBER	DESCRIPTION	ADDITIONAL INFORMATION
	TP SS 1621	CPI Sock, 16-21cm	Highly durable sock that acts as a noise barrier and protects the foot from debris.
	TP SSX 1618	CPI Exo Sock, 16-18cm	
	TP SSK 1621	CPI Sock, 16-21cm, 6-pack	