

ADJUSTABLE HEEL | INTELLIWEAVE FOOT BASE | DYNAMIC PYLON OPTION



The Accent provides 2" (5.1 cm) of heel height adjustment through a simple push of a button. The foot comes with a contoured, soft ankle fairing that locks into the shell and prevents cosmetic buckling when the foot is adjusted at various heel heights. The Accent provides a service-free option for individuals who desire a cosmetically appealing foot.

INCLUDED

Endo foot includes: bonded foot shell and ankle fairing

Dynamic Pylon foot includes: bonded foot shell, ankle fairing, DP sleeve adapter and choice of pylon adapter

ACCENT PART NUMBER

AC	SIDE	SHELL COLOR*	MOUNTING†	BUTTON PLACEMENT**	SIZE	WIDTH‡	FIRMNESS CATEGORY
	L OR R	C OR B	IP, DF, DM OR D4	M OR L	21-28	N OR W	D 1-3

*(C)aucasian or (B)rown. †(IP) Integrated Pyramid, (DF) Dynamic Pylon Female, (DM) Dynamic Pylon Male or (D4) Dynamic Pylon 4-hole. ** (M)edial placement or (L)ateral placement. ‡(N)arrow or (W)ide. Wide only available in 23-26cm. Example part number: AC LCIP 24N D2

ACCENT FIRMNESS CATEGORIES



PATIENT WEIGHT	0-120lbs	121-140	141-160	161-180	181-220	221-250
SIZE	21-28 cm					25-28 cm
LOW IMPACT	1	1	2	2	3	3
MODERATE IMPACT	1	2	2	3	3	3

BUILD HEIGHT

	21-24 cm	25-28 cm
IP	3.3 in	3.9 in
DP 4-hole	7.8 in	8.0 in
DP Male	7.8 in	8.1 in
DP Female	8.3 in	8.5 in

*25cm with Envirosheel. ** The listing of codes with these products should not be construed as a guarantee for coverage or payment. Ultimate responsibility for the coding of services/products rests with the individual practitioner. ***Caucasian and Brown.

TECHNICAL SPECIFICATIONS

FUNCTION	Adjustable Heel
SIZES	21-28 cm
MOUNTING	Endo (IP) D.Pylon (DP)
WEIGHT LIMIT	220 lbs (21-24 cm) 250 lbs (25-28 cm)
WARRANTY	2 years
WEIGHT*	608 g (IP) 761 g (DP)
L-CODES**	IMPACT LEVEL L5981 + L5986 + L5990 
WATER CAPABILITY	ENVIROSHELL***  Weatherproof  standard

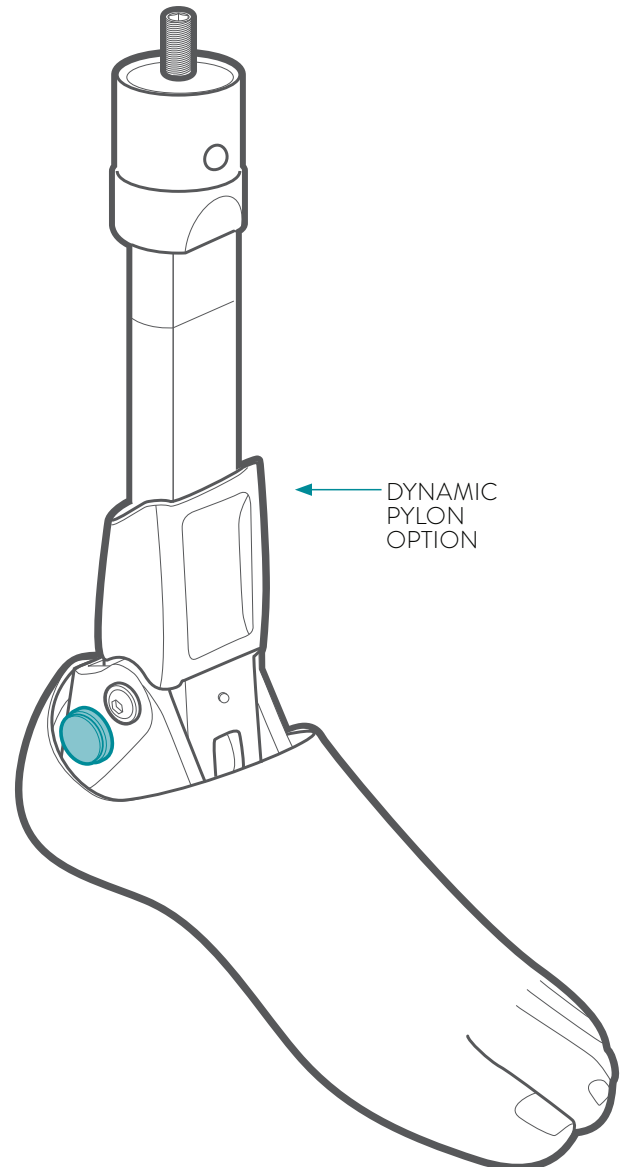
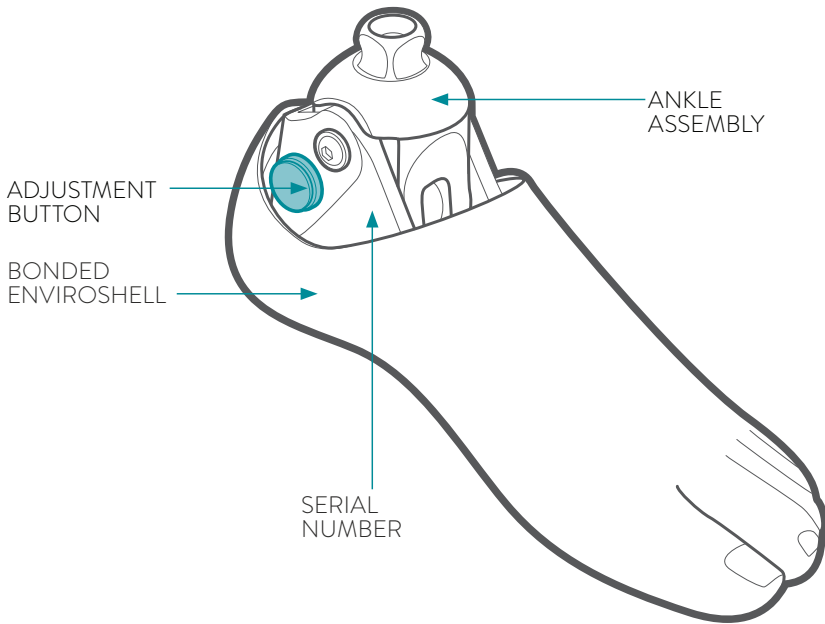
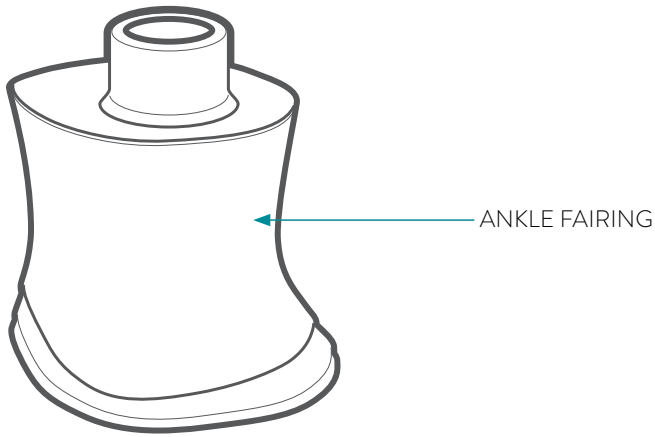

DP MOUNTING ADAPTERS	PART NUMBER	DESCRIPTION
	DP SA 2124	DP Sleeve Adapter, 21-24cm
	DP SA 2530	DP Sleeve Adapter, 25-30cm
	DP ESAS 2124	DP Extension Adapter Short, 6mm, 21-24cm
	DP ESAS 2530	DP Extension Adapter Short, 6mm, 25-30cm
	DP ESAL 2124	DP Extension Adapter Long, 25mm, 21-24cm
	DP ESAL 2530	DP Extension Adapter Long, 25mm, 25-30cm
	DP FPA 2124	DP Female Pylon Adapter, 21-24cm
	DP FPA 2530	DP Female Pylon Adapter, 25-30cm
	DP MPA 2124	DP Male Pylon Adapter, 21-24cm
	DP MPA 2530	DP Male Pylon Adapter, 25-30cm
	DP 4HPA 2124	DP 4-Hole Pylon Adapter, 21-24cm
	DP 4HPA 2530	DP 4-Hole Pylon Adapter, 25-30cm

ANKLE FAIRING	PART NUMBER (LEFT/RIGHT)	DESCRIPTION	ADDITIONAL INFORMATION
	AC FLC 2124	AC FRC 2124	Fairing (left or right) Caucasian, 21-24cm
	AC FLC 2526	AC FRC 2526	Fairing (left or right) Caucasian, 25-26cm
	AC FLC 2728	AC FRC 2728	Fairing (left or right) Caucasian, 27-28cm
	AC FLB 2124	AC FRB 2124	Fairing (left or right) Brown, 21-24cm
	AC FLB 2526	AC FRB 2526	Fairing (left or right) Brown, 25-26cm
	AC FLB 2728	AC FRB 2728	Fairing (left or right) Brown, 27-28cm

Pre-shaped soft foam fairing for cosmetically finishing a prosthesis. Includes CA glue.

HARDWARE	PART NUMBER	DESCRIPTION
	CP SSET	Super Set Screws (8pc) M8 x 14mm
	DP RS	DP Sleeve Retention Screw
	DP ACS	DP Adapter Clamp Screw, M4 x 22mm
	DP CSK 2124	DP Adapter Clamp Screw Kit, 21-24cm
	DP CSK 2530	DP Adapter Clamp Screw Kit, 25-30cm

TOOLS	PART NUMBER	DESCRIPTION
	CP HK 4	Hex Key, 4mm
	GA GEL	Cyanoacrylate Adhesive Gel (CA glue)
	DP POS	DP Push Out Screw
	DP CJ	DP Cutting Jig

SHELLTREAD	PART NUMBER (LEFT/RIGHT)	DESCRIPTION	ADDITIONAL INFORMATION
	AC TLN xx	AC TRN xx	Shelltread (left or right), Neutral (indicate size)

Increases durability and prevents premature wear of foot shell.